

**VESSEL PARTICULARS:**

|                         |                         |
|-------------------------|-------------------------|
| LIGHTSHIP DISPLACEMENT: | 14.0 t                  |
| FULL LOAD DISPLACEMENT: | 22.5 t                  |
| LOA:                    | 16.0 m                  |
| LWL:                    | 14.7 m                  |
| BEAM:                   | 4.7 m                   |
| MAXIMUM DRAFT:          | 1.63 m                  |
| CREW:                   | 8                       |
| DECK AREA:              | 36 m <sup>2</sup>       |
| MAIN ENGINE:            | MTU S60 (552kW@2300rpm) |
| GEARBOX:                | MG5114A                 |
| PROPELLER:              | Ø33" FIXED PITCH        |
| GENERATOR:              | T.B.A.                  |
| FUEL CAPACITY:          | 1800 L                  |
| FRESH WATER:            | 500 L                   |
| SULLAGE:                | 200 L                   |
| SPEED (LIGHTSHIP):      | 26.0 knots              |
| SPEED (FULL LOAD):      | 19.5 knots              |
| SURVEY:                 | USL CLASS 2B            |

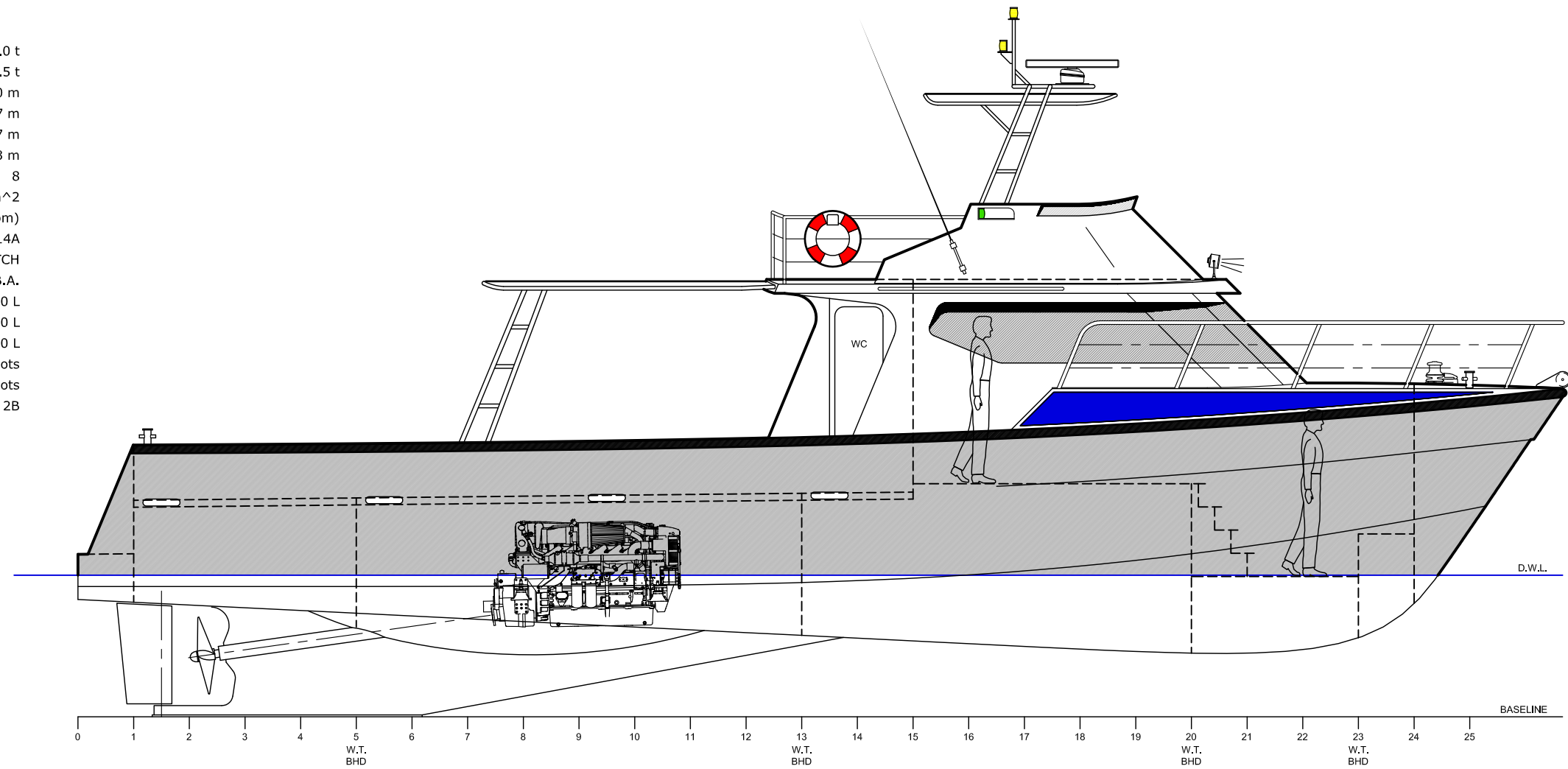

OUTBOARD PROFILE

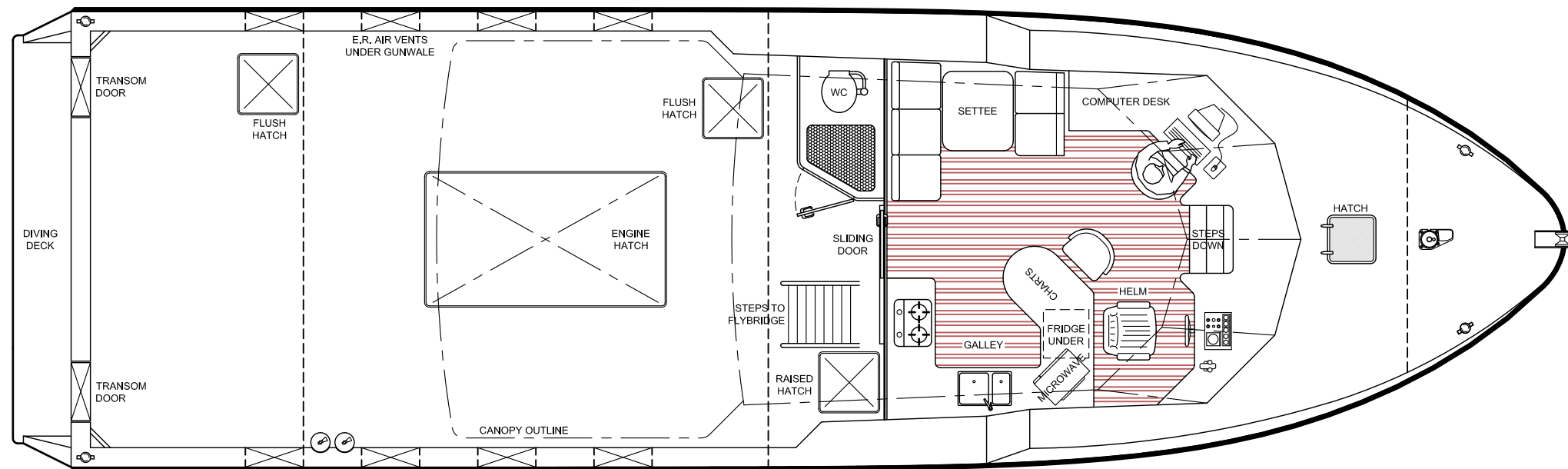

PLAN ON MAIN DECK

