

# 18m OFFSHORE CATAMARAN

## VESSEL PARTICULARS

LIGHTSHIP DISPLACEMENT:	25 tonne
MAXIMUM DISPLACEMENT:	35 tonne
LOA:	18.3 m
LWL:	16.3 m
BEAM:	6.0 m
DRAFT:	0.9 m
FUEL:	5200 L
FRESH WATER:	300 L

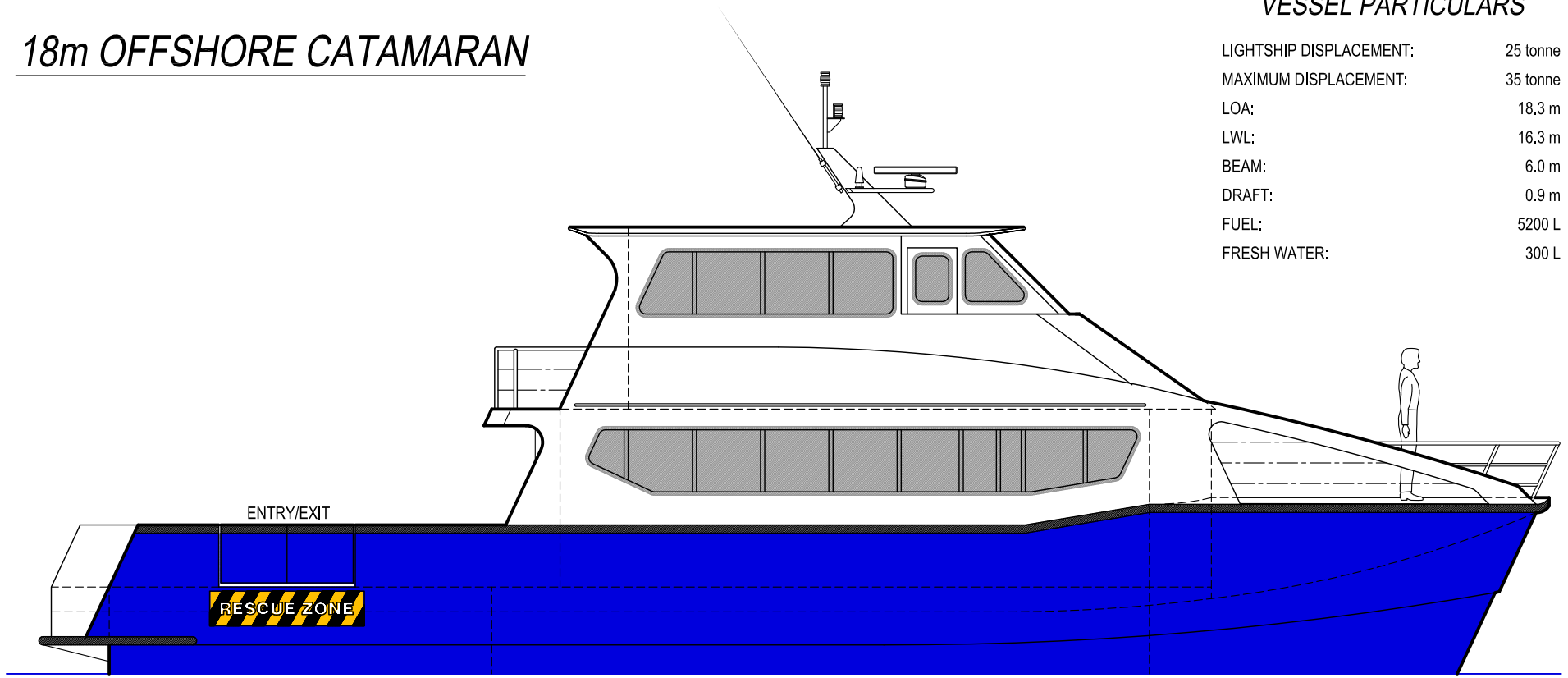

STBD PROFILE

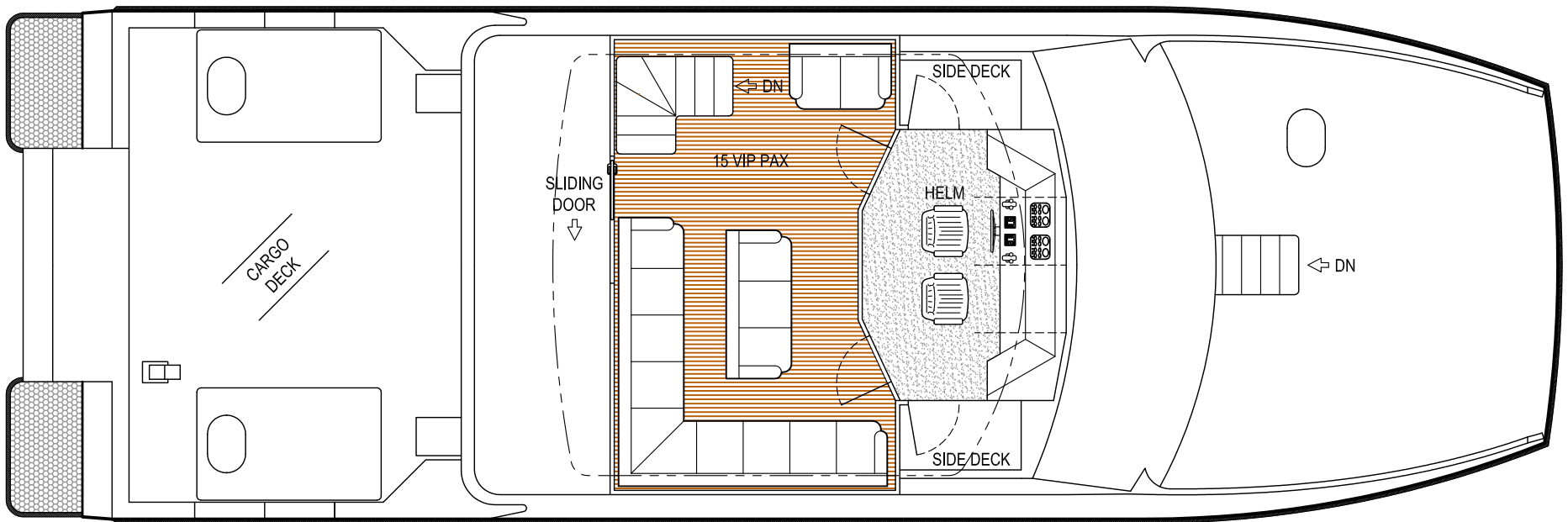
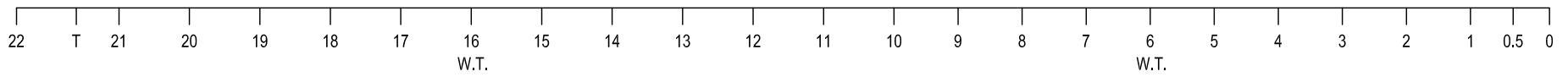

UPPER DECK PLAN

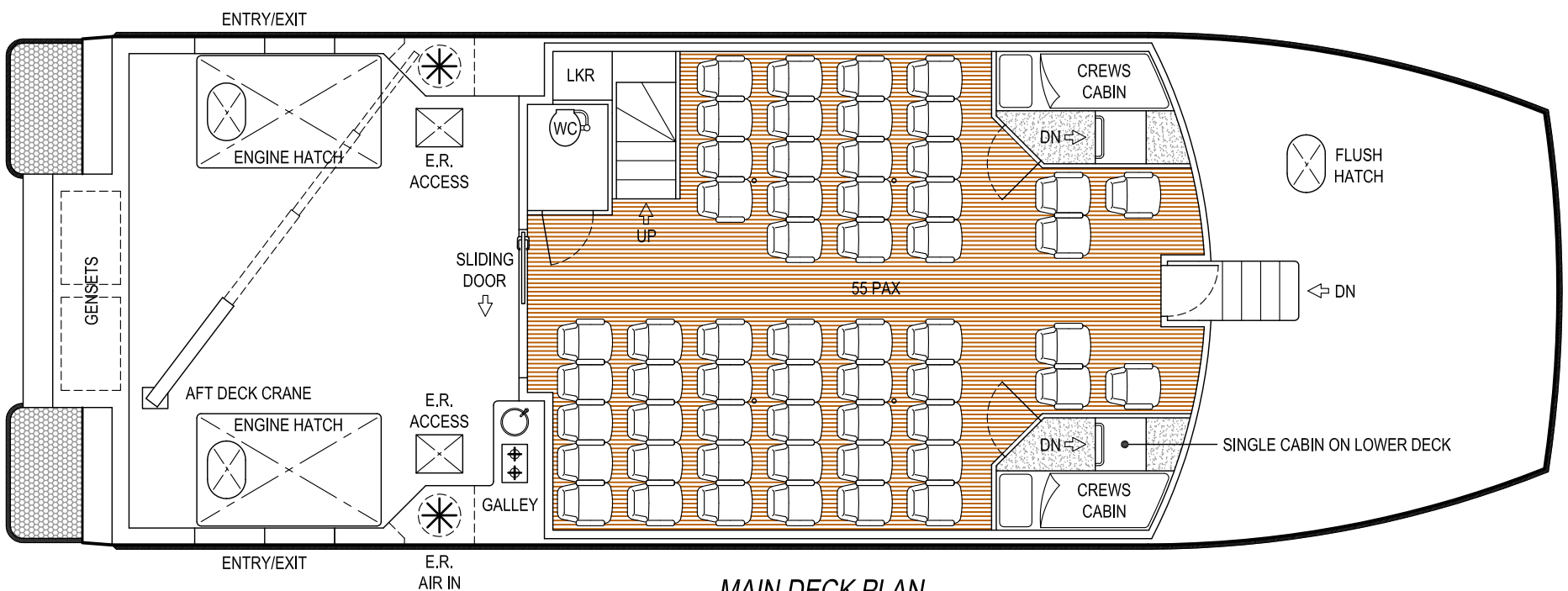

MAIN DECK PLAN

## VESSEL PARTICULARS

SULLAGE TANK:	300 L
PASSENGERS:	70
CREW:	3
MAIN ENGINES:	2x MAN D2842 LE410
WATERJETS:	2x Castoldi TD400
GENSETS:	2x 12 kVA
TOP SPEED:	27-29 knots



CONSULTING NAVAL ARCHITECTS  
P: +618 9437 3096 E: andrew@abmarine.com.au

GENERAL ARRANGEMENT		DATE: 11/03/10
DWG #: 7041B-101		SHEET 1 OF 1
REV: E	SCALE: 1:75	